



**QAQC LAB**

[www.qclabequipment.com](http://www.qclabequipment.com)

## QAQC LiquiThief

Liquid Sampling Without Costly Cleaning

Revolutionised liquid sampling with the introduction of the LiquiThief. This sampler is ideal for use with low viscosity liquids (eg. water).

- Assembled & Packed in a Cleanroom
- Individually Bagged
- FDA & EU 10/2011 Conforming Materials
- BSE/TSE Free
- Full Batch Traceability
- ATEX Rated (500mm and 1000mm lengths only)
- Available Sterile (gamma irradiated\*)

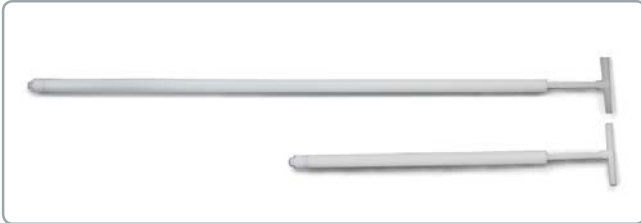

1. Insert the sampler into the product
2. At the required depth pull up the handle. The sample will be drawn into the sampler
3. Withdraw sampler
4. Push down handle to expel the sample

Note: The further the handle is pulled the greater the sample volume

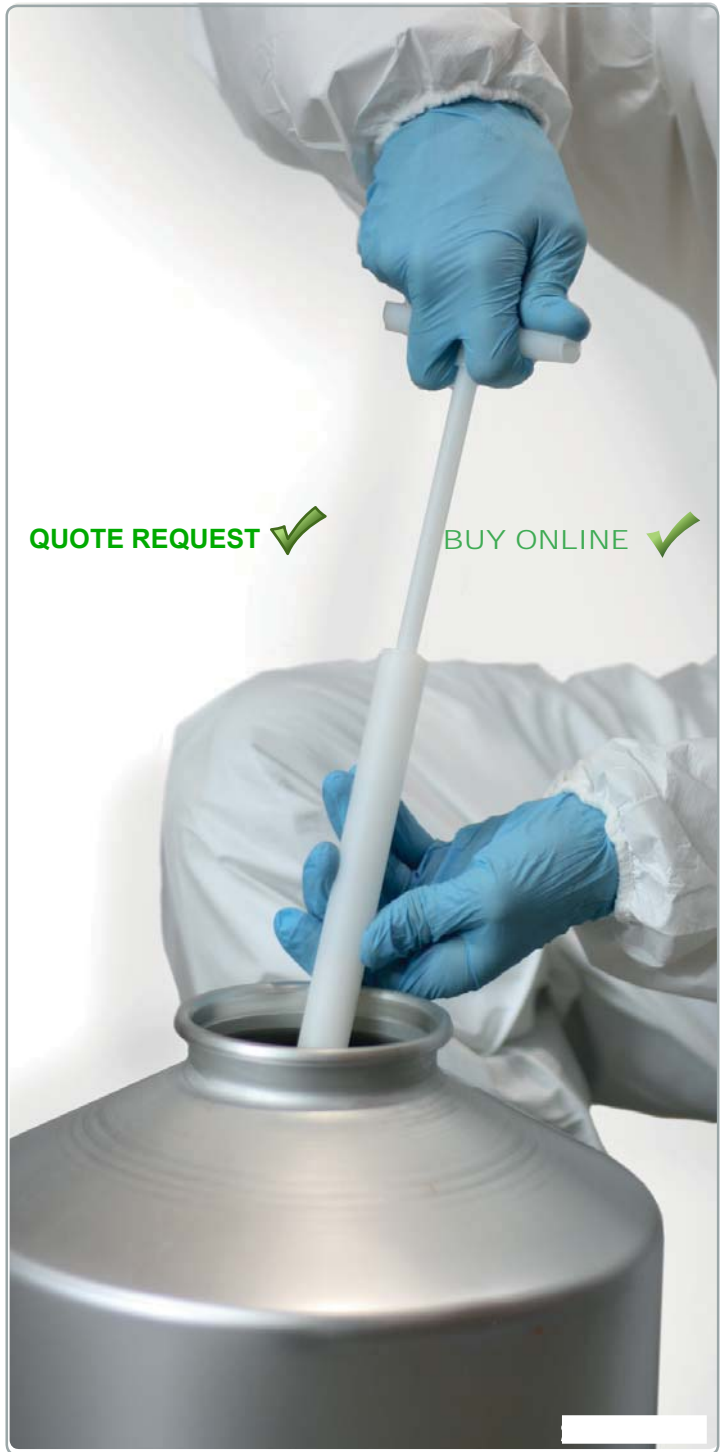
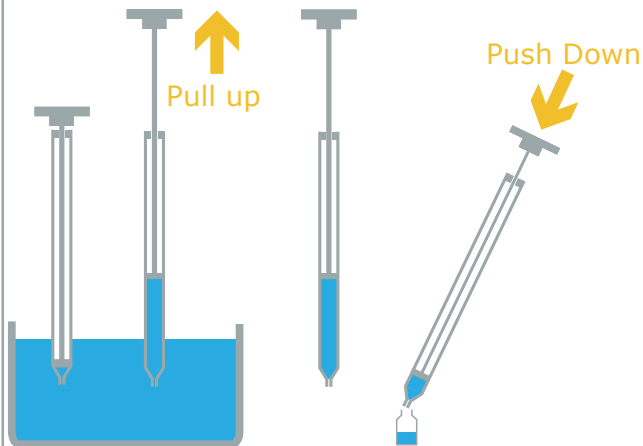

[QUOTE REQUEST](#) ✓

[BUY ONLINE](#) ✓

Disposables

Stock No.	Length	Pre-Sterilized	Vol	Diameter	Material	Per Box
675 8050H500	500mm	No	100ml	21mm	HDPE	20
675 8050H500S	500mm	Yes	100ml	21mm	HDPE	20
675 8050H1000	1000mm	No	190ml	21mm	HDPE	20
675 8050H1000S	1000mm	Yes	190ml	21mm	HDPE	20
675 8050H1500	1500mm	No	300ml	21mm	HDPE	20
675 8050H1500S	1500mm	Yes*	300ml	21mm	HDPE	20
675 8050P500	500mm	No	100ml	21mm	PP	20
6758050P1000	1000mm	No	190ml	21mm	PP	20

## Disposable Visco Thief

Single use Cream & Oil Sampler

Avoid time consuming cleaning with our disposable range of ViscoThief samplers. The Disposable ViscoThief is a single use sampler that is designed for use with viscous materials.

- Suitable for creams, pastes and gels
- 10mm diameter sampling hole in the tip
- Fully welded construction (no adhesives or screws are used)
- Assembled in a medical clean room
- Each sampler is individually wrapped
- Made from HDPE (FDA acceptable grade conforms to CFR 177.1520)
- FDA acceptable silicone rubber is used for the piston seal - CFR 177.2600
- ATEX Rated for Zones 0,1 & 2 (contact Sampling Systems for full details)

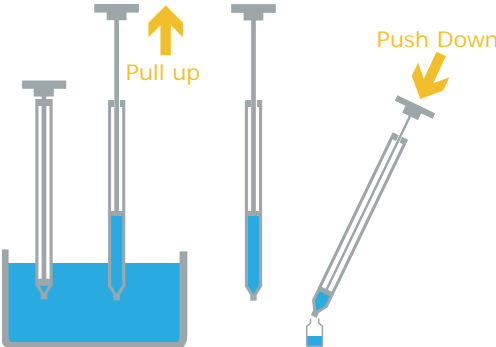

**Operation**

1. Insert the sampler into the product
2. At the required depth pull up the handle. The sample will be drawn into the sampler
3. Withdraw sampler
4. Push down handle to expel the sample



**QUOTE REQUEST** ✓

**BUY ONLINE** ✓



Stock No.	Length	Pre-Sterilized	Volume	Material	Outer Diameter	Per Box
675 8055H500	500mm	No	100ml	HDPE	21mm	20
675 8055H500S	500mm	Yes	100ml	HDPE	21mm	20
675 8055H1000	1000mm	No	190ml	HDPE	21mm	20
675 8055H1000S	1000mm	Yes	190ml	HDPE	21mm	20
675 8055H1500	1500mm	No	290ml	HDPE	21mm	20
675 8055H1500S	1500mm	Yes	290ml	HDPE	21mm	20